

# LSTT

**Single Wall tube. A Premium grade heat shrink tube primarily used for electrical insulation. Available in several colours.**

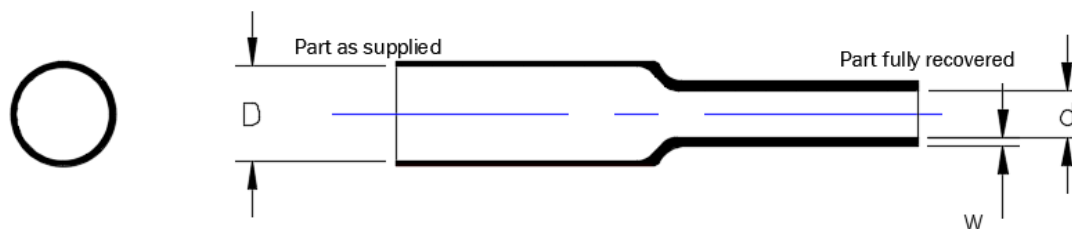

## PRODUCT DIMENSIONS

SIZE	Inside Diameter as supplied (min) mm (inch) D	Inside Diameter after recovery (max) mm (inch) d	Wall Thickness after recovery (nom) mm (inch) W	Wall Thickness Tolerance after recovery mm (inch)
1.6	1.6 (0.063)	0.8 (0.031)	0.50 (0.018)	0.12 (0.005)
2.4	2.4 (0.093)	1.2 (0.046)	0.55 (0.022)	0.12 (0.005)
3.2	3.2 (0.125)	1.6 (0.063)	0.55 (0.022)	0.12 (0.005)
4.8	4.8 (0.187)	2.4 (0.093)	0.55 (0.022)	0.12 (0.005)
6.4	6.4 (0.250)	3.2 (0.125)	0.65 (0.026)	0.15 (0.006)
9.5	9.5 (0.375)	4.8 (0.187)	0.65 (0.026)	0.15 (0.006)
12.7	12.7 (0.500)	6.4 (0.250)	0.65 (0.026)	0.15 (0.006)
19.0	19.0 (0.748)	9.5 (0.375)	0.80 (0.032)	0.15 (0.006)
25.4	25.4 (1.000)	12.7 (0.500)	0.95 (0.037)	0.18 (0.007)
32.0	32.0 (1.260)	16.0 (0.630)	1.05 (0.041)	0.20 (0.008)
38.0	38.0 (1.496)	19.0 (0.748)	1.05 (0.041)	0.20 (0.008)
52.0	52.0 (2.047)	26.0 (1.024)	1.14 (0.045)	0.18 (0.007)

### LSTT – STANDARD SIZE REFERENCE DIMENSIONAL DRAWING



©2020 TE Connectivity Ltd. family of companies  
All Rights Reserved

DIMENSIONS IN  
mm (Inch)

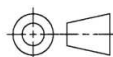

SHEET

1 of 2

TITLE

**LSTT – IRRADIATED MODIFIED  
POLYOLEFIN SINGLE WALL HEAT SHRINK  
TUBING**

NO

**LSTT – Standard sizes**

REV

**A**

REV      ENGINEERING CHANGE      CHK      DATE

# LSTT

## PRODUCT INFORMATION

General use single wall Polyolefin Tubing.  
Shrink Ratio – 2:1  
Longitudinal Shrinkage on full recovery – 0 to -10%  
Material conforms to TE Specification RW-2051  
Standard Colours: Black, White, Red, Blue, Yellow, Clear  
Non-Standard Colours: Brown, Orange, Green, Violet, Grey  
Non- Flame Retardant

Tubing cut to specific lengths can be supplied from the product sizes  
referenced within this drawing.

Cut length tolerances are as per the following table:

STANDARD CUTTING TOLERANCES (mm)	
CUT LENGTH	TOLERANCE
Up to 9.9mm	±0.5mm
10mm to 24.9mm	±1.0mm
25mm to 54.9mm	±1.5mm
55mm to 99.9mm	±3.0mm
100mm to 149.9mm	±4.0mm
150mm to 499.9mm	±5.0mm
500mm to 1200mm	±12.5mm



TE Connectivity Ltd. family of companies

SHEET

2 of 2

NO.

**LSTT – Standard  
sizes**

REV

**A**